



# fienza<sup>®</sup>

*Stone & Timber Top*

VANITIES



*Your Vanity*  
YOUR WAY





### Like a tailor-made vanity, without the wait

With five warehouses throughout Australia, all stock is readily available. This means you can create a custom-look vanity without the long lead time.



### Eco-friendly E0 board

Fienza cabinets are manufactured with highly water-resistant, 2-pac medium density fibreboard (MDF). The majority of our cabinet range is made from E0 grade board, which has 50% lower formaldehyde emission than the minimum Australian Standard (E1 board). This significantly reduces the risk of potential adverse health effects from formaldehyde, ensuring a safe product that can be installed and used immediately in the home.



### FSC certified

Our universal vanity cabinets are sourced from manufacturers that hold Forest Stewardship Council® Certification (FSC). This ensures that the raw materials used in our products are only sourced from sustainable, managed plantation forests.



### Australian made & recycled hardwood

Fienza's hardwood vanity tops are manufactured from reclaimed timber sourced from the demolition of old Queensland-style houses. Each top has its own unique look and is made from recycled Spotted Gum or Blackbutt hardwood.





# Your Vanity

---

## YOUR WAY

Fienza's Universal Vanities range allows you to choose from an extensive range of cabinets, tops, basins and accents to create your vanity, your way.

### ABOVE COUNTER BASIN STYLES

Above counter basins make a bold statement in the design of your bathroom and can feature as a beautiful centre-piece for your vanity.

Find inspiration on pages 12-23.

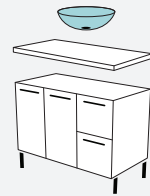

### SEMI-INSET BASIN STYLES

Semi-inset basins provide a balance between above counter and undermounted basin styles, providing more space while retaining an above counter look.

Find inspiration on pages 24-25.



### UNDERMOUNT BASIN STYLES

The slimline profile of undermount basin-tops give a clean, minimalist look. They are supplied as one, with the basin already attached to your choice of stone top.

Find inspiration on pages 26-29.

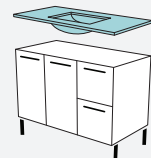

### YOUR PERFECT VANITY IN 4 EASY STEPS

- 1 Choose your cabinet  
20 styles available
- 2 Choose your vanity top  
Up to 7 styles available
- 3 Choose your basin style  
Above Counter, Semi-Inset, or Undermounted Basin-Top
- 4 Choose your accents  
Multiple styles available





## Choose your cabinet

With 20 different cabinet styles to choose from, there is a universal cabinet to suit your bathroom design. All universal cabinets come with soft-close drawers and doors as standard (excludes selected UNICAB™ models) and are designed to fit any Fienza® stone or timber top, giving you customisation without the fuss.

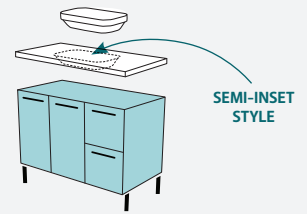
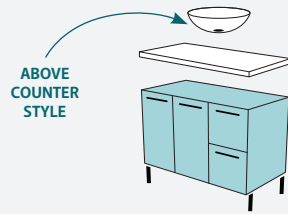

**EDGE Scandi Oak**  
wall-hung cabinet

750 Left	\$425	75SL
750 Right	\$425	75SR
900 Left	\$480	90SL
900 Right	\$480	90SR
1200	\$650	120S
1500	\$850	150S



**EDGE Industrial**  
wall-hung cabinet

750 Left	\$425	75XL
750 Right	\$425	75XR
900 Left	\$480	90XL
900 Right	\$480	90XR
1200	\$650	120X
1500	\$850	150X



**FINGERPULL Matte White**  
wall-hung cabinet

750 Left	\$425	75ZL
750 Right	\$425	75ZR
900 Left	\$480	90ZL
900 Right	\$480	90ZR
1200	\$650	120Z
1500	\$850	150Z



**FINGERPULL Matte Black**  
wall-hung cabinet

750 Left	\$575	75ZBL
750 Right	\$575	75ZBR
900 Left	\$650	90ZBL
900 Right	\$650	90ZBR
1200	\$800	120ZB
1500	\$1000	150ZB



**EDGE Scandi Oak**  
cabinet on kickboard

750 Left	\$425	75SKL
750 Right	\$425	75SKR
900 Left	\$480	90SKL
900 Right	\$480	90SKR
1200	\$650	120SK
1500	\$850	150SK



**EDGE Industrial**  
cabinet on kickboard

750 Left	\$425	75XKL
750 Right	\$425	75XKR
900 Left	\$480	90XKL
900 Right	\$480	90XKR
1200	\$650	120XK
1500	\$850	150XK



**FINGERPULL Matte White**  
cabinet on kickboard

750 Left	\$499	75ZKL
750 Right	\$499	75ZKR
900 Left	\$554	90ZKL
900 Right	\$554	90ZKR
1200	\$740	120ZK
1500	\$950	150ZK



**FINGERPULL Matte Black**  
cabinet on kickboard

750 Left	\$649	75ZBKL
750 Right	\$649	75ZBKR
900 Left	\$724	90ZBKL
900 Right	\$724	90ZBKR
1200	\$890	120ZBK
1500	\$1100	150ZBK

TIPS

Fienza universal vanity cabinets come with soft-close drawers and doors as standard (\*excludes selected UNICAB™ models).

Configuration of doors and drawers varies for each cabinet width. Check full cabinet specifications at [fienza.com.au](http://fienza.com.au)

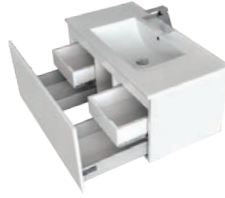

DRAWERS

Choose left-hand or right-hand drawers where available.

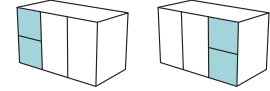

FINGERPULL Gloss White cabinet on legs

750 Left	\$425	75AL
750 Right	\$425	75AR
900 Left	\$480	90AL
900 Right	\$480	90AR
1200	\$650	120A



UNICAB™ Gloss White cabinet on legs\*

750 Left	\$425	75NLWL
750 Right	\$425	75NLWR
900 Left	\$480	90NLWL
900 Right	\$480	90NLWR
1200	\$650	120NLW

\*Soft-close doors only



UNICAB™ Gloss White wall-hung cabinet

750 Left	\$425	75JL
750 Right	\$425	75JR
900 Left	\$480	90JL
900 Right	\$480	90JR
1200	\$650	120J
1500	\$850	150J
1800	\$1000	180J



UNICAB™ Gloss White cabinet on kickboard\*

750 Left	\$425	75NKWL
750 Right	\$425	75NKWR
900 Left	\$480	90NKWL
900 Right	\$480	90NKWR
1200	\$650	120NKW
1500	\$850	150NKW
1800	\$1000	180NKW

\*Soft-close doors only



FINGERPULL Gloss White wall-hung cabinet

750 Left	\$425	75FL
750 Right	\$425	75FR
900 Left	\$480	90FL
900 Right	\$480	90FR
1200	\$650	120F
1500	\$850	150F



HAMPTON Satin White wall-hung cabinet

750	\$575	75T-C
900	\$650	90T-C
1200	\$800	120T-C



QUEST Gloss White wall-hung cabinet

750	\$575	75Q
900	\$650	90Q
1200	\$800	120Q



MANU Gloss White wall-hung cabinet

750	\$575	75H
900	\$650	90H
1200	\$800	120H



FINGERPULL Gloss White cabinet on kickboard

750 Left	\$425	75CL
750 Right	\$425	75CR
900 Left	\$480	90CL
900 Right	\$480	90CR
1200	\$650	120C
1500	\$850	150C



HAMPTON Satin White cabinet on kickboard

750	\$635	75TK
900	\$710	90TK
1200	\$860	120TK



QUEST Gloss White cabinet on kickboard

750	\$635	75QK
900	\$710	90QK
1200	\$860	120QK

NEW



AMATO Cabinets  
View the full range in our Amato brochure



# 2

## Choose your vanity top

We have 7 beautifully crafted vanity tops that are designed to fit onto any Fienza® universal cabinet. Choose from a range of styles, colours and materials.

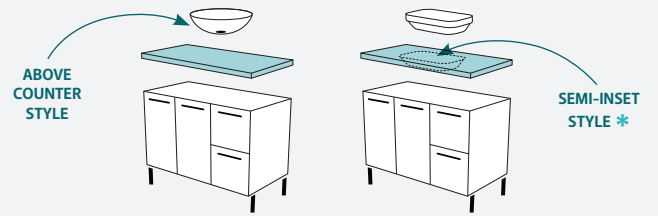

### Bianco Marble

Bianco Marble stone tops are crafted with a light marble effect to add a touch of elegance to your vanity.

- Marble-effect, engineered quartz stone top
- 20mm thick, 465mm deep

**750mm** • \$275 • 504-102  
**900mm** • \$310 • 504-103  
**1200mm** • \$350 • 504-104  
**1500mm** • \$551 • 504-105  
**1800mm** • \$651 • 504-106

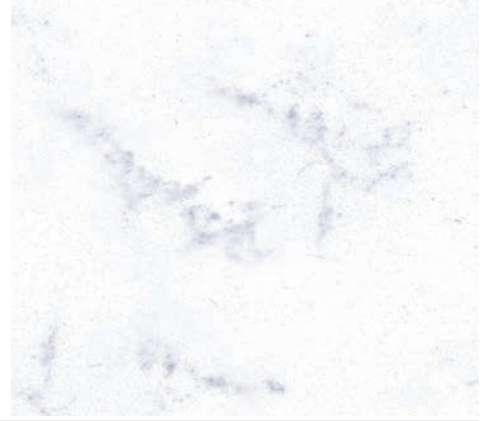

### Calacatta Marble

Add opulence to your bathroom with the stunning, luxurious style of Calacatta marble-effect stone from Fienza®.

- Marble-effect, engineered quartz stone top
- 20mm thick, 465mm deep

**750mm** • \$495 • 508-102  
**900mm** • \$585 • 508-103  
**1200mm** • \$770 • 508-104  
**1500mm** • \$1000 • 508-105  
**1800mm** • \$1200 • 508-106



### Crystal Pure

Crystal pure stone adds a clean, minimalist look with a crystal white finish.

- Crystal white, engineered quartz stone top
- 20mm thick, 465mm deep

**750mm** • \$275 • 503-102  
**900mm** • \$310 • 503-103  
**1200mm** • \$350 • 503-104  
**1500mm** • \$551 • 503-105  
**1800mm** • \$651 • 503-106



### Roman Sand

Roman Sand stone tops feature a light sand, patterned look that complement a wide variety of bathroom designs and styles.

- Light sand, engineered quartz stone top
- 20mm thick, 465mm deep

**750mm** • \$275 • 502-102  
**900mm** • \$310 • 502-103  
**1200mm** • \$350 • 502-104  
**1500mm** • \$551 • 502-105  
**1800mm** • \$651 • 502-106

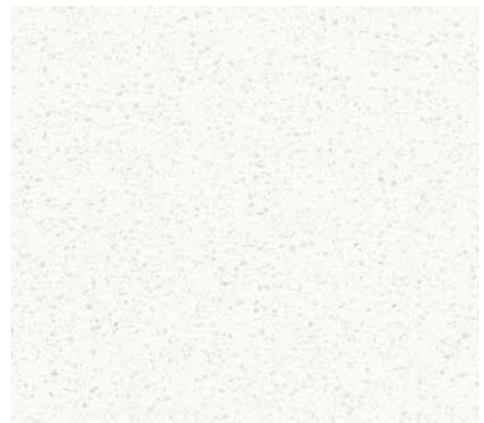

**\* STONE & HARDWOOD TOP CUTTING**

Additional charges may apply for cutting tap holes, basin holes or waste holes depending on your final configuration. Please speak with your Retailer or contact us for more information.

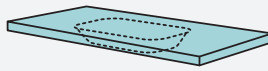
**Dove Grey**

Dove Grey stone has a concrete-look, making it an excellent centrepiece for rustic or industrial inspired bathroom designs.

- Dove grey, concrete-look, engineered quartz stone top
- 20mm thick, 465mm deep

**750mm • \$275 • 505-102**  
**900mm • \$310 • 505-103**  
**1200mm • \$350 • 505-104**  
**1500mm • \$551 • 505-105**  
**1800mm • \$651 • 505-106**

**Black Sparkle**

The Black Sparkle stone top complements a minimalist bathroom design with a touch of sparkle.

- Sparkling black, engineered quartz stone top
- 20mm thick, 465mm deep

**750mm • \$275 • 501-102**  
**900mm • \$310 • 501-103**  
**1200mm • \$350 • 501-104**  
**1500mm • \$551 • 501-105**  
**1800mm • \$651 • 501-106**

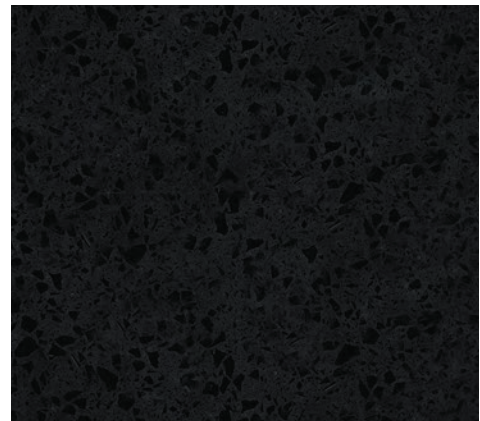
**Australian Hardwood**

These carefully crafted hardwood tops are made from natural, 100% recycled Australian timber, making each piece unique.

- Natural, 100% recycled timber
- 40mm thick, 465mm deep

**750mm • \$730 • 700-101**  
**900mm • \$850 • 700-102**  
**1200mm • \$1000 • 700-103**  
**1500mm • \$1400 • 700-104**  
**1800mm • \$1700 • 700-105**



# 3

## Choose your above counter or semi-inset basin

With over 50 basins to choose from, you are destined to find a style to suit your vanity.

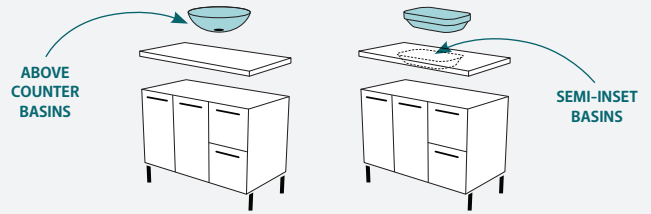

### SEMI-INSET STYLES

All prices include semi-inset hole cut for vanity top.



PARISA Ceramic Gloss White  
1 tap hole • \$389 • RB5033-1-SEMI



PARISA Ceramic Gloss White  
No tap hole • \$389 • RB5033-0-SEMI



SARAH Ceramic Gloss White  
For Stone Tops (centre basin-hole & 12 o'clock tap hole) • \$199 • RB4071  
For Stone Tops (other) & Hardwood  
\$339 • RB4071-SEMI



KADOS Cast Stone Matte White  
For Stone Tops (centre basin-hole & 12 o'clock tap hole) • \$399 • CSB05  
For Stone Tops (other) & Hardwood  
\$539 • CSB05-SEMI



ALISON Ceramic Gloss White  
1 tap hole • \$389 • TR4975-SEMI  
(not suitable for three tap holes)



REBA Ceramic Gloss White  
\$339 • RB3134D-SEMI  
(available with 10 o'clock or 2 o'clock tap hole only)



DAYO Ceramic Gloss White  
\$389 • RB5032-SEMI



RAK RESORT Ceramic Gloss White  
\$389 • 605500W-SEMI

### ABOVE COUNTER - GLASS STYLES



CRISTELLO Clear Glass  
\$449 • RB201



CRISTELLO Electric Silver Glass  
\$599 • RB205



CRYSTAL CLEAR  
\$199 • 615CLEAR

### ABOVE COUNTER - CAST STONE STYLES



ANTONIA Matte White  
\$499 • CSB088



BAHAMA Matte White  
\$399 • CSB01



BAHAMA Matte Grey  
\$599 • CSB01-GREY



BAHAMA Matte Black  
\$599 • CSB01-MB



BAHAMA Gloss Black  
\$499 • CSB01-B



NERO Matte White  
\$499 • CSB63



BAHAMA MKII Matte White  
\$499 • CSB61



CLASSIQUE 600 Matte White  
\$449 • CSB03



CLASSIQUE 600 Matte Grey  
\$649 • CSB03-GREY



CLASSIQUE 600 Matte Black  
\$649 • CSB03-MB



LEXY Matte White  
\$399 • CSB038



RONDO 600 Matte White  
One tap hole • \$449 • CSB010  
Three tap holes • \$499 • CSB010-3



RONDO 400 Matte White  
One tap hole • \$399 • CSB09  
Three tap holes • \$449 • CSB09-3



CLASSIQUE 420 Matte White  
\$399 • CSB02



CLASSIQUE 420 Matte Grey  
\$599 • CSB02-GREY



CLASSIQUE 420 Matte Black  
\$599 • CSB02-MB



ABOVE COUNTER - CERAMIC STYLES



BABY MODENA Gloss White  
One tap hole • \$175 • TR4549  
(not suitable for three tap holes)



HELEN JUNIOR Gloss White  
One tap hole • \$199 • TR4148  
Three tap holes • \$249 • TR4148-3



HELEN Gloss White  
One tap hole • \$249 • RB71  
Three tap holes • \$299 • RB71-3



MODENA Gloss White  
One tap hole • \$275 • RB07N  
Three tap holes • \$325 • RB07N-3



WILLOW Gloss White  
One tap hole • \$249 • RB7033  
Three tap holes • \$299 • RB7033-3



COMO Gloss White  
One tap hole • \$199 • 7078W  
Three tap holes • \$249 • 7078W-3



RAINE Gloss White  
One tap hole • \$230 • RB2113  
(not suitable for three tap holes)



PETRA Gloss White  
One tap hole • \$249 • RB2173  
Three tap holes • \$299 • RB2173-3



PETRA MINI Gloss White  
One tap hole • \$249 • RB2177  
Three tap holes • \$299 • RB2177-3



NICOLE Gloss White  
One tap hole • \$199 • TR4049  
(not suitable for three tap holes)



JENNA Gloss White  
\$199 • RB09



EVIE Gloss White  
\$199 • TR4322



LUCIANA Gloss White  
\$249 • RB2178



LINCOLN 350 Gloss White  
\$199 • RB04



LINCOLN 570 Gloss White  
\$249 • RB05



CHICA 405 Gloss White  
One tap hole • \$199 • RB2201  
(not suitable for three tap holes)



CHICA 500 Gloss White  
One tap hole • \$199 • RB2202  
(not suitable for three tap holes)



KOKO 370 Gloss White  
\$199 • RB184



KOKO 465 Gloss White  
\$199 • RB185



CHLOE Gloss White  
\$199 • RB2245



ALIX Gloss White  
\$249 • RB3130



LULU Gloss White  
\$199 • TR4037



PAOLA Gloss White  
\$199 • RB3078



KEETO Gloss White  
\$249 • RB814



REBA Gloss White  
\$199 • RB3134



REBA Matte White  
\$329 • RB3134W



REBA Matte Pink  
\$329 • RB3134P



REBA Matte Green  
\$329 • RB3134G



REBA Matte Blue  
\$329 • RB3134BLUE



REBA Matte Light Grey  
\$329 • RB3134LG



REBA Matte Dark Grey  
\$329 • RB3134DG



REBA Matte Black  
\$329 • RB3134B



LUCIANA Matte Black  
\$430 • RB2178B



PETRA Matte Black  
One tap hole • \$460 • RB2173B  
Three tap holes • \$510 • RB2173B-3

# 4

## Choose your accents

Complete the look with a range of accents to suit your style.

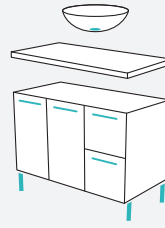

### Multifunction Pop-Up Wastes

(32/40mm waste)

Multifunction dome pop-up wastes are convertible for use with or without an overflow. The entire top section of the waste can pop-out for easy cleaning.



**Chrome**  
\$49  
WAS71



**Brushed Nickel**  
\$80  
WAS71BN



**Gun Metal**  
\$80  
WAS71GE

### Pop-Up Wastes

Dome cap pop-up wastes to suit any colour scheme, available in three cap materials and a range of colours. Choose the style to suit your basin.

#### Ceramic Cap (32mm waste)



**Gloss White**  
\$60

No overflow • WAS81  
With overflow • WAS82



**Matte Pink**  
\$60

No overflow • WAS59P  
With overflow • WAS58P



**Matte Green**  
\$60

No overflow • WAS59GR  
With overflow • WAS58GR



**Matte Blue**  
\$60

No overflow • WAS59BLUE  
With overflow • WAS58BLUE



**Matte White**  
\$60

No overflow • WAS59MW  
With overflow • WAS58MW



**Matte Light Grey**  
\$60

No overflow • WAS59LG  
With overflow • WAS58LG



**Matte Dark Grey**  
\$60

No overflow • WAS59DG  
With overflow • WAS58DG



**Matte Black**  
\$60

No overflow • WAS59MB  
With overflow • WAS58MB

#### Metal Cap (32mm waste)



**Chrome**  
\$30

No overflow • WAS59  
With overflow • WAS58



**Brushed Nickel**  
\$80

No overflow • WAS59BN  
With overflow • WAS58BN



**Urban Brass**  
\$80

No overflow • WAS59UB  
With overflow • WAS58UB

#### Cast Stone Cap



**Matte White**  
32mm • \$65

No overflow • WAS59W  
With overflow • WAS58W

40mm • \$80

No overflow • WAS56W  
With overflow • WAS57W



**Matte Grey**  
32mm • \$65

No overflow • WAS59G  
With overflow • WAS58G

40mm • \$80

No overflow • WAS56G  
With overflow • WAS57G



**Matte Black**  
32mm • \$65

No overflow • WAS59B  
With overflow • WAS58B

40mm • \$80

No overflow • WAS56B  
With overflow • WAS57B

## Handles

If you've chosen a UNICAB™ cabinet, you can customise your vanity with different handle designs and finishes.

UNICAB™ (All cabinet sizes)



**BOW Chrome**  
Included with cabinet  
HANDLEG160  
(Valued at \$7.50 each)



**BOW Matte Black**  
\$7.50 each  
HANDLEGB160



**SQUARE Chrome**  
\$7.50 each  
HANDLEC160



**EMPIRE Chrome**  
\$15 each  
HANDLEW160



**RAIL Chrome**  
\$7.50 each  
HANDLEA160



**DELGADO Chrome**  
\$7.50 each  
HANDLED160

Note: Cabinet styles AMATO, EDGE, FINGERPULL, HAMPTON, MANU & QUEST do not require handles.

## Aluminium Pull-Channel Sets

For QUEST cabinets only



**Gloss White**  
750 width • \$50 • RAIL75W  
900 width • \$59 • RAIL90W  
1200 width • \$65 • RAIL120W



**Matte Black**  
750 width • \$50 • RAIL75MB  
900 width • \$59 • RAIL90MB  
1200 width • \$65 • RAIL120MB

## Legs

Available in various heights & finishes, you have the option to install your cabinet on legs rather than kickboard.



**ROUND Matte Black**  
\$15 each  
120mm • LEG120BLKRO



**SQUARE Chrome**  
\$12.50 each  
120mm • LEG120SQ  
200mm • LEG200SQ  
250mm • LEG250SQ  
300mm • LEG300SQ



**ROUND Chrome**  
\$12.50 each  
120mm • LEG120RO  
200mm • LEG200RO  
250mm • LEG250RO  
300mm • LEG300RO

## Fill Panels

When your vanity is installed beside a wall, this panel fills the gap between the protruding basin-top and the cabinet to provide a clean and tidy finish.

For shorter cabinets, the panel can be trimmed to the size you need.

Size (WxHxD):  
50 x 880 x 18mm



**Gloss White**  
\$20 • F-BF18



**Matte White**  
\$20 • BF18MW



**Scandi Oak**  
\$20 • BF18S



**Industrial**  
\$20 • BF18X



**Matte Black**  
\$20 • BF18MB

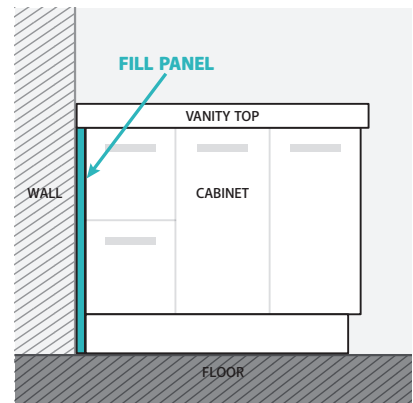

# Scandi ABOVE COUNTER STYLE



RONDO 400 Matte White Cast Stone  
\$399 • CSB09



PETRA MINI Gloss White Ceramic  
\$249 • RB2177



CHICA 405 Gloss White Ceramic  
\$199 • RB2201



RONDO 600 Matte White Cast Stone  
\$449 • CSB010



PETRA Gloss White Ceramic  
\$249 • RB2173



CHICA 500 Gloss White Ceramic  
\$199 • RB2202



## Universal Vanity Combination

**\$1488**

Includes:

EDGE Scandi Oak  
1200mm Wall-Hung Cabinet  
\$650 • 120S

CRYSTAL PURE  
1200mm Stone Top  
\$350 • 503-104

CHICA 500 Gloss White  
Ceramic Basin  
\$199 • RB2202

CITANI Basin Mixer  
WELS 5 Star rated, 5L/min  
\$259 • 216103

Chrome Pop-Up Waste,  
no Overflow  
\$30 • WAS59



Universal Vanity Combination

**\$1689**

Includes:

FINGERPULL Matte White  
1200mm Wall-Hung Cabinet  
\$650 • 120Z

CRYSTAL PURE  
1200mm Stone Top  
\$350 • 503-104

REBA Matte White  
Ceramic Basin  
\$329 • RB3134W

EMPIRE Wall Mixer with Spout  
WELS 5 Star rated, 5L/min  
\$330 • 221106

Chrome Pop-Up Waste,  
no Overflow  
\$30 • WAS59



Universal Vanity Combination

**\$1828**

Includes:

QUEST Gloss White  
1200mm Wall-Hung Cabinet  
with Chrome Pull-Channel Accents  
\$800 • 120Q

DOVE GREY Stone Top, 1200mm  
\$350 • 505-104

LUCIANA Gloss White  
Ceramic Basin  
\$249 • RB2178

ELEANOR Brushed Nickel  
Gooseneck Basin Mixer with  
White Ceramic Handle  
WELS 5 Star rated, 5.5L/min  
\$349 • 202104BN

Brushed Nickel  
Multifunction Pop-Up Waste  
\$80 • WAS71BN

Quest cabinets come with Chrome  
colour pull-channel rails as standard.  
Matte Black and Gloss White accent  
rails can be purchased separately.

# Industrial Chic

## ABOVE COUNTER STYLE



LINCOLN 350 Gloss White Ceramic  
\$199 • RB04



LINCOLN 570 Gloss White Ceramic  
\$249 • RB05



MODENA Gloss White Ceramic  
\$275 • RB07N



CLASSIQUE 420 Matte Grey Cast Stone  
\$599 • CSB02-GREY



CLASSIQUE 600 Matte Grey Cast Stone  
\$649 • CSB03-GREY



COMO Gloss White Ceramic  
\$199 • 7078W



### Universal Vanity Combination

**\$1888**

Includes:

EDGE Industrial  
1200mm Wall-Hung Cabinet  
\$650 • 120X

CRYSTAL PURE  
1200mm Stone Top  
\$350 • 503-104

LUCIANA Gloss White  
Ceramic Basin  
\$249 • RB2178

ELEANOR Brushed Nickel  
Gooseneck Sink Mixer with  
Brushed Nickel Handle  
WELS 5 Star rated, 5.5L/min  
\$559 • 202109NN

Brushed Nickel  
Multifunction Pop-Up Waste  
\$80 • WAS71BN



## Universal Vanity Combination

\$2238

Includes:

QUEST Gloss White  
Wall-Hung Cabinet, 1200mm  
with Chrome Pull-Channel Accents  
\$800 • 120Q

DOVE GREY 1200mm Stone Top  
\$350 • 505-104

CLASSIQUE 600  
Matte White Cast Stone Basin  
\$449 • CSB03

ELEANOR Brushed Nickel  
Gooseneck Sink Mixer with  
Brushed Nickel Handle  
WELS 5 Star rated, 5.5L/min  
\$559 • 202109NN

Brushed Nickel  
Multifunction Pop-Up Waste  
\$80 • WAS71BN

Quest cabinets come with Chrome  
colour pull-channel rails as standard.  
Matte Black and Gloss White accent  
rails can be purchased separately.



## Universal Vanity Combination

\$1564

Includes:

UNICAB Gloss White  
Cabinet on Legs, 1200mm  
\$650 • 120NLW

BLACK SPARKLE  
1200mm Stone Top  
\$350 • 501-104

COMO Gloss White Ceramic Basin  
\$199 • 7078W

KOKO Matte Black Basin Mixer  
WELS 5 Star rated, 5L/min  
\$260 • 218103B

Matte Black Ceramic Cap  
Pop-Up Waste, with Overflow  
\$60 • WAS58MB

BOW Matte Black Handles (x6)  
\$7.50 each • HANDLEGB160

Vanity cabinets with accents, such as  
handles and legs, come with Chrome  
as standard. Matte Black accents are  
purchased separately.

# Modern Vintage

## ABOVE COUNTER STYLE



KEETO Gloss White Ceramic  
\$249 • RB814



LEXY Matte White Cast Stone  
\$399 • CSB038



KOKO 370 Gloss White Ceramic  
\$199 • RB184



NICOLE Gloss White Ceramic  
\$199 • TR4049



JENNA Gloss White Ceramic  
\$199 • RB09



EVIE Gloss White Ceramic  
\$199 • TR4322



### Universal Vanity Combination

**\$2578**

Includes:

HAMPTON Satin White  
1200mm Wall-Hung Cabinet  
\$800 • 120T-C

AUSTRALIAN HARDWOOD  
1200mm Top  
\$1000 • 700-103

KOKO 465 Gloss White  
Ceramic Basin  
\$199 • RB185

LILLIAN Brushed Nickel  
Shepherds Crook Sink Mixer  
WELS 5 Star rated, 6L/min  
\$499 • 336106BN

Brushed Nickel  
Multifunction Pop-Up Waste  
\$80 • WAS71BN





## Universal Vanity Combination

\$1908

Includes:

HAMPTON Satin White  
1200mm Wall-Hung Cabinet  
\$800 • 120T-C

CRYSTAL PURE  
1200mm Stone Top  
\$350 • 503-104

REBA Gloss White  
Ceramic Basin  
\$199 • RB3134

LILLIAN Matte Black  
Shepherds Crook Sink Mixer  
WELS 5 Star rated, 6L/min  
\$499 • 336106BK

Matte Black Ceramic Cap  
Pop-Up Waste, no Overflow  
\$60 • WAS59MB



## Universal Vanity Combination

\$2398

Includes:

HAMPTON Satin White  
1200mm Wall-Hung Cabinet  
\$800 • 120T-C

CALACATTA MARBLE  
1200mm Stone Top  
\$770 • 508-104

LEXY Matte White  
Cast Stone Basin  
\$399 • CSB038

LILLIAN Chrome  
Shepherds Crook Sink Mixer  
WELS 5 Star rated, 6L/min  
\$399 • 336106

Chrome Pop-Up Waste,  
no Overflow  
\$30 • WAS59

# Natural & Organic

## ABOVE COUNTER STYLE



BAHAMA Matte White Cast Stone  
\$399 • CSB01



ANTONIA Matte White Cast Stone  
\$499 • CSB088



BAHAMA MKII Matte White Cast Stone  
\$499 • CSB61



DAYO Gloss White Ceramic  
Semi-Inset Style Basin  
\$389 • RB5032-SEMI  
(includes basin-hole cut in top)



CHLOE Gloss White Ceramic  
\$199 • RB2245



PAOLA Gloss White Ceramic  
\$199 • RB3078



### Universal Vanity Combination

**\$2618**

Includes:

HAMPTON Satin White  
1200mm Wall-Hung Cabinet  
\$800 • 120T-C

AUSTRALIAN HARDWOOD  
1200mm Top  
\$1000 • 700-103

DAYO Gloss White Ceramic  
Semi-Inset Style Basin  
\$389 • RB5032-SEMI  
(includes basin-hole cut in top)

LILLIAN Chrome  
Shepherds Crook Sink Mixer  
WELS 5 Star rated, 6L/min  
\$399 • 336106

Chrome Pop-Up Waste,  
no Overflow  
\$30 • WAS59



## Universal Vanity Combination

\$2459

Includes:

MANU Gloss White  
1200mm Wall-Hung Cabinet  
\$800 • 120H

CALACATTA MARBLE 1200mm Stone Top  
\$770 • 508-104

ANTONIA Matte White  
Cast Stone Basin  
\$499 • CSB088

CITANI Chrome Tall Basin Mixer  
WELS 5 Star rated, 5L/min  
\$360 • 216107

Chrome Pop-Up Waste,  
no Overflow  
\$30 • WAS59



MANU wall-hung cabinets feature one large soft-close drawer with a discrete pull-channel along the top edge. Four internal drawers keep your vanity perfectly organised.



## Universal Vanity Combination

\$1963

Includes:

EDG Scandi Oak  
1200mm Wall-Hung Cabinet  
\$650 • 120S

ROMAN SAND  
1200mm Stone Top  
\$350 • 502-104

BAHAMA Matte White  
Cast Stone Basin  
\$399 • CSB01

LILLIAN Champagne  
Shepherds Crook Sink Mixer  
WELS 5 Star rated, 6L/min  
\$499 • 336106BB

Matte White Stone Cap  
Pop-Up Waste, no Overflow  
\$65 • WAS59W

# Reba Rainbow

## ABOVE COUNTER STYLE



REBA Gloss White Ceramic  
\$199 • RB3134



REBA Matte White Ceramic  
\$329 • RB3134W



REBA Matte Pink Ceramic  
\$329 • RB3134P



REBA Matte Green Ceramic  
\$329 • RB3134G



REBA Matte Blue Ceramic  
\$329 • RB3134BLUE



REBA Matte Light Grey Ceramic  
\$329 • RB3134LG



REBA Matte Dark Grey Ceramic  
\$329 • RB3134DG



REBA Matte Black Ceramic  
\$329 • RB3134B



Gloss White  
\$60 • WAS81



Matte White  
\$60 • WASS9MW



Matte Pink  
\$60 • WAS59P



Matte Green  
\$60 • WASS9GR



Matte Blue  
\$60 • WASS9BLUE



Matte Light Grey  
\$60 • WASS9LG



Matte Dark Grey  
\$60 • WASS9DG



Matte Black  
\$60 • WASS9MB



### Universal Vanity Combination

**\$1948**

Includes:

HAMPTON Satin White  
1200mm Cabinet on Kickboard  
\$860 • 120TK

CRYSTAL PURE  
1200mm Stone Top  
\$350 • 503-104

REBA Matte Blue  
Ceramic Basin  
\$329 • RB3134BLUE

ELEANOR Brushed Nickel  
Gooseneck Basin Mixer with  
White Ceramic Handle  
WELS 5 Star rated, 5.5L/min  
\$349 • 202104BN

Matte Blue Ceramic Cap  
Pop-Up Waste, no Overflow  
\$60 • WASS9BLUE



## Universal Vanity Combination

\$2038

Includes:

HAMPTON Satin White  
1200mm Wall-Hung Cabinet  
\$800 • 120T-C

CRYSTAL PURE  
1200mm Stone Top  
\$350 • 503-104

REBA Matte Pink  
Ceramic Basin  
\$329 • RB3134P

LILLIAN Champagne  
Shepherds Crook Sink Mixer  
WELS 5 Star rated, 6L/min  
\$499 • 336106BB

Matte Pink Ceramic Cap  
Pop-Up Waste, no Overflow  
\$60 • WAS59P



## Universal Vanity Combination

\$1839

Includes:

QUEST Gloss White  
1200mm Wall-Hung Cabinet  
with Chrome Pull-Channel Accents  
\$800 • 120Q

BIANCO MARBLE  
1200mm Stone Top  
\$350 • 504-104

REBA Matte Green  
Ceramic Basin  
\$329 • RB3134G

EMPIRE Wall Mixer with Spout  
WELS 5 Star rated, 5L/min  
\$330 • 221106

Chrome Metal Cap  
Pop-Up Waste, no Overflow  
\$30 • WAS59

Quest cabinets come with Chrome colour pull-channel rails as standard. Matte Black and Gloss White accent rails can be purchased separately.

# Matte Black

## ABOVE COUNTER STYLE



REBA Matte Black Ceramic  
\$329 • RB3134B



LICIANA Matte Black Ceramic  
\$430 • RB2178B



PETRA Matte Black Ceramic  
\$460 • RB2173B



BAHAMA Matte Black Cast Stone  
\$599 • CSB01-MB



CLASSIQUE 420 Matte Black Cast Stone  
\$599 • CSB02-MB



CLASSIQUE 600 Matte Black Cast Stone  
\$649 • CSB03-MB



Universal Vanity Combination

**\$2213**

Includes:

FINGERPULL Matte Black  
1200mm Wall-Hung Cabinet  
\$800 • 120ZB

CRYSTAL PURE  
1200mm Stone Top  
\$350 • 503-104

CLASSIQUE 600  
Matte Black Cast Stone  
\$649 • CSB03-MB

KOKO Matte Black  
Wall Mixer with Spout  
WELS 5 Star rated, 5L/min  
\$349 • 218106B

Matte Black Stone Cap  
Pop-Up Waste, no Overflow  
\$65 • WAS59B



Extra storage can be added with a matching mirror cabinet.

Universal Vanity & Mirror Cabinet Combination

\$3613

Includes:

Matte Black Mirror Cabinet with Undershelf, 1200mm  
\$650 • PSC1200SB

FINGERPULL Matte Black Wall-Hung Cabinet, 1200mm  
\$800 • 120ZB

Australian Hardwood Vanity Top, 1200mm  
\$1000 • 700-103

BAHAMA Matte Black Cast Stone Basin  
\$599 • CSB01-MB

Matte Black Cast Stone Cap Pop-Up Waste, no Overflow  
\$65 • WAS59B

LILLIAN Champagne Shepherds Crook Mixer  
WELS 5 Star rated, 6L/min  
\$499 • 336106BB

# Semi-Inset Style

All prices below include semi-inset hole cut for vanity top

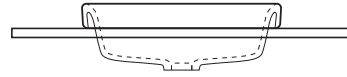

REBA Gloss White Ceramic  
\$339 • RB3134D-SEMI  
(available with 10 o'clock or 2 o'clock tap hole only)



DAYO Ceramic Gloss White  
\$389 • RB5032-SEMI



KADOS Cast Stone Matte White  
For Stone Tops (centre basin-hole & 12 o'clock tap hole) • \$399 • CSB05  
For Stone Tops (other) & Hardwood • \$539 • CSB05-SEMI



ALISON Ceramic Gloss White  
1 tap hole • \$389 • TR4975-SEMI  
(not suitable for three tap holes)



PARISA Ceramic Gloss White  
1 tap hole • \$389 • RB5033-1-SEMI  
No tap hole • \$389 • RB5033-0-SEMI



SARAH Ceramic Gloss White  
For Stone Tops (centre basin-hole & 12 o'clock tap hole) • \$199 • RB4071  
For Stone Tops (other) & Hardwood • \$339 • RB4071-SEMI



Universal Vanity Combination

**\$1789**

Includes:

FINGERPULL Matte Black  
1200mm Wall-Hung Cabinet  
\$800 • 120ZB

CRYSTAL PURE  
1200mm Stone Top  
\$350 • 503-104

SARAH Semi-Inset  
Gloss White Ceramic Basin  
\$199 • RB4071  
(includes basin-hole cut in top)

KOKO Matte Black  
Medium Basin Mixer  
WELS 5 Star rated, 5L/min  
\$380 • 218109B

Matte Black Ceramic Cap  
Pop-Up Waste, no Overflow  
\$60 • WAS59MB





## Universal Vanity Combination

**\$1958**

Includes:

QUEST Gloss White  
1200mm Wall-Hung Cabinet  
with Chrome Pull-Channel Accents  
\$800 • 120Q

DOVE GREY 1200mm Stone Top  
\$350 • 505-104

REBA Semi-Inset  
Gloss White Ceramic Basin  
\$339 • RB3134D-SEMI  
(includes basin-hole cut in top)

ELEANOR Matte Black  
Basin Mixer, Black Handle  
WELS 5 Star rated, 5.5L/min  
\$409 • 202104BL

Matte Black Ceramic Cap  
Pop-Up Waste, no Overflow  
\$60 • WAS59MB

Quest cabinets come with Chrome  
colour pull-channel rails as standard.  
Matte Black and Gloss White accent rails  
can be purchased separately (see page 11).



## Universal Vanity Combination

**\$2388**

Includes:

EDGE Industrial  
1200mm Wall-Hung Cabinet  
\$650 • 120X

CALACATTA MARBLE  
1200mm Stone Top  
\$770 • 508-104

DAYO Semi-Inset  
Gloss White Ceramic Basin  
\$389 • RB5032-SEMI  
(includes basin-hole cut in top)

LILLIAN Brushed Nickel  
Shepherds Crook Sink Mixer  
WELS 5 Star rated, 6L/min  
\$499 • 336106BN

Brushed Nickel  
Multifunction Pop-Up Waste  
\$80 • WAS71BN

# Undermounted Basin-Tops

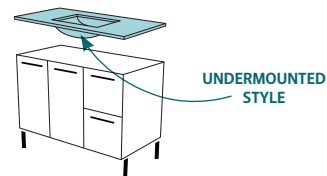

The slimline profile of undermounted basin-tops provide a clean, minimalist look and ample counter space.

The undermounted basin comes pre-joined to the stone top, so all you have to do is select your favourite style!

View the full range of options on our website: [fienza.com.au](https://fienza.com.au)



Dove Grey



Black Sparkle



Bianco Marble



Calacatta Marble



Crystal Pure



Roman Sand



Universal Vanity Combination

**\$1678**

Includes:

HAMPTON Satin White  
1200mm Wall-Hung Cabinet  
\$800 • 120T-C

BIANCO MARBLE  
1200mm Stone Top with  
SARAH Undermounted  
Gloss White Ceramic Basin  
\$549 • SI120

ELEANOR Chrome  
Shepherds Crook Basin Mixer,  
White Ceramic Handle  
WELS 5 Star rated, 5.5L/min  
\$299 • 202103

Chrome Metal Cap  
Pop-Up Waste, with Overflow  
\$30 • WAS58



## Universal Vanity Combination

\$2074

Includes:

HAMPTON Satin White  
1200mm Wall-Hung Cabinet  
\$800 • 120T-C

CALACATTA MARBLE  
1200mm Stone Top with  
SARAH Undermounted  
Gloss White Ceramic Basin  
\$969 • SM120

LILLIAN Chrome  
Shepherds Crook Basin Tap Set  
WELS 5 Star rated, 6L/min  
\$225 • 336101  
(add \$50 for three tap holes in top)

Chrome Metal Cap  
Pop-Up Waste, with Overflow  
\$30 • WAS58



## Universal Vanity Combination

\$1679

Includes:

FINGERPULL Matte Black  
1200mm Wall-Hung Cabinet  
\$800 • 120ZB

CRYSTAL PURE  
1200mm Stone Top with  
SARAH Undermounted  
Gloss White Ceramic Basin  
\$549 • SC120

KOKO Matte Black  
Basin Mixer  
WELS 5 Star rated, 5L/min  
\$260 • 218103B

Matte Black Ceramic Cap  
Pop-Up Waste, with Overflow  
\$60 • WAS58MB

Matte Black Metal  
Overflow Ring  
\$10 • OVERFLOWBLK



Universal Vanity Combination

**\$1529**

Includes:

EDGE Scandi Oak  
1200mm Wall-Hung Cabinet  
\$650 • 120S

CRYSTAL PURE  
1200mm Stone Top with  
SARAH Undermounted  
Gloss White Ceramic Basin  
\$549 • SC120

KOKO Matte Black  
Basin Mixer  
WELS 5 Star rated, 5L/min  
\$260 • 218103B

Matte Black Ceramic Cap  
Pop-Up Waste, with Overflow  
\$60 • WAS58MB

Matte Black Metal  
Overflow Ring  
\$10 • OVERFLOWBLK



Universal Vanity Combination

**\$1488**

Includes:

EDGE Industrial  
1200mm Wall-Hung Cabinet  
\$650 • 120X

ROMAN SAND  
1200mm Stone Top with  
SARAH Undermounted  
Gloss White Ceramic Basin  
\$549 • SA120

CITANI Chrome  
Basin Mixer  
WELS 5 Star rated, 5L/min  
\$259 • 216103

Chrome Metal Cap  
Pop-Up Waste, with Overflow  
\$30 • WAS58



Universal Vanity Combination

\$1569

Includes:

QUEST Gloss White  
1200mm Wall-Hung Cabinet  
with Chrome Pull-Channel Accents  
\$800 • 120Q

DOVE GREY  
1200mm Stone Top with  
SARAH Undermounted  
Gloss White Ceramic Basin  
\$549 • SD120

KOKO Chrome  
Basin Mixer  
WELS 5 Star rated, 5L/min  
\$190 • 218103

Chrome Metal Cap  
Pop-Up Waste, with Overflow  
\$30 • WAS58

Quest cabinets come with Chrome colour pull-channel rails as standard. Matte Black and Gloss White accent rails can be purchased separately.



Universal Vanity Combination

\$1679

Includes:

MANU Gloss White  
1200mm Wall-Hung Cabinet  
\$800 • 120H

BLACK SPARKLE  
1200mm Stone Top with  
SARAH Undermounted  
Gloss White Ceramic Basin  
\$549 • SB120

KOKO Matte Black Basin Mixer  
WELS 5 Star rated, 5L/min  
\$260 • 218103B

Matte Black Ceramic Cap  
Pop-Up Waste, with Overflow  
\$60 • WAS58MB

Matte Black Metal Overflow Ring  
\$10 • OVERFLOWBLK

MANU wall-hung cabinets feature one large soft-close drawer with a discrete pull-channel along the top edge. Four internal drawers keep your vanity perfectly organised.

# Matching Mirror Cabinets

Fienza mirror cabinets are customised with side panels to match your new bathroom vanity, and are available with or without an undershelf. Creating a consistent style for your bathroom is easy!



**Gloss White 750mm**  
With Undershelf  
\$340 • PSC750SW  
No Undershelf  
\$290 • PSC750W



**Gloss White 900mm**  
With Undershelf  
\$395 • PSC900SW  
No Undershelf  
\$345 • PSC900W



**Gloss White 1200mm**  
With Undershelf  
\$495 • PSC1200SW  
No Undershelf  
\$445 • PSC1200W



**Scandi Oak 750mm**  
With Undershelf  
\$340 • PSC750SS  
No Undershelf  
\$290 • PSC750S



**Scandi Oak 900mm**  
With Undershelf  
\$395 • PSC900SS  
No Undershelf  
\$345 • PSC900S



**Scandi Oak 1200mm**  
With Undershelf  
\$495 • PSC1200SS  
No Undershelf  
\$445 • PSC1200S



**Industrial 750mm**  
With Undershelf  
\$340 • PSC750SX  
No Undershelf  
\$290 • PSC750X



**Industrial 900mm**  
With Undershelf  
\$395 • PSC900SX  
No Undershelf  
\$345 • PSC900X



**Industrial 1200mm**  
With Undershelf  
\$495 • PSC1200SX  
No Undershelf  
\$445 • PSC1200X

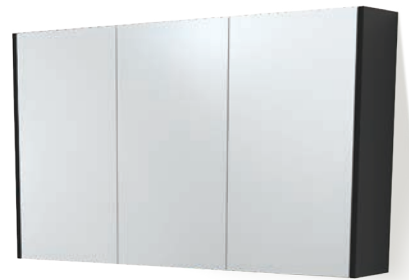

**Matte Black 750mm**  
With Undershelf  
\$450 • PSC750SB  
No Undershelf  
\$390 • PSC750B



**Matte Black 900mm**  
With Undershelf  
\$510 • PSC900SB  
No Undershelf  
\$445 • PSC900B



**Matte Black 1200mm**  
With Undershelf  
\$650 • PSC1200SB  
No Undershelf  
\$545 • PSC1200B



Extra storage  
can be added  
with a matching  
mirror cabinet.

Universal Vanity  
& Mirror Cabinet  
Combination

**\$2333**

Includes:

Scandi Oak Mirror Cabinet  
with Undershef, 1200mm  
\$495 • PSC1200SS

EDGE Scandi Oak  
Wall-Hung Cabinet, 1200mm  
\$650 • 120S

Bianco Marble Stone  
Vanity Top, 1200mm  
\$350 • 504-104

REBA Gloss White  
Ceramic Basin  
\$199 • RB3134

ELEANOR Brushed Nickel Gooseneck  
Sink Mixer, Brushed Nickel Handle  
WELS 5 Star rated, 5.5L/min  
\$559 • 202109NN

Brushed Nickel Multifunction  
Pop-Up Waste  
\$80 • WAS71BN



fienza

*Beautiful,  
Quality Bathware*

At Fienza our core passion is to excite customers with new, innovative and cutting-edge designer bathroom products.

Our commitment to international quality standards has ensured that Fienza continues to be the preferred choice for beautiful bathrooms all over Australia.

Fienza® products are available through all leading bathroom and plumbing retailers.

For more information, contact us or visit our website:

P: (07) 3490 6700

E: [contactus@fienza.com.au](mailto:contactus@fienza.com.au)

**[www.fienza.com.au](http://www.fienza.com.au)**

Retailer/Distributor:

CAT-A

BRISBANE • SYDNEY • MELBOURNE • ADELAIDE • PERTH